

Easy-Touch® Lancing Device w/ Ejector

Select Depth

Twist to select (9 settings)

Lancet Activator Button

Push to engage

Lancet Ejector

Push forward to eject lancet

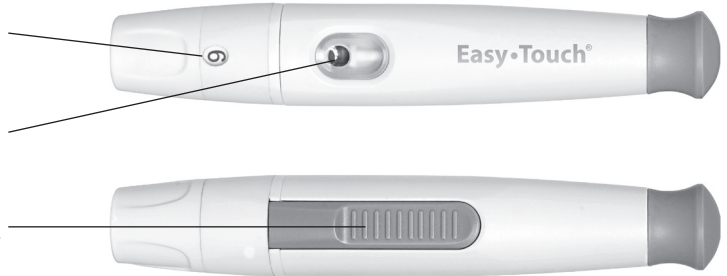

Lancing Device Instructions

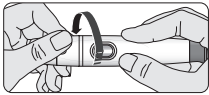

Unscrew the lancing device cap.

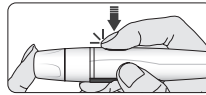

To prick your finger, push the lancet activator button.

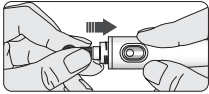

Insert a sterile lancet into the lancing device.

CAUTION

If the blood smears or runs, do not use that sample. Dry the area and gently squeeze another drop or puncture a new site.

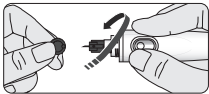

Twist the protective cover off. Do not discard.

Disposing of Your Lancets

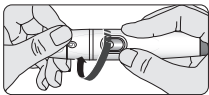

Replace the lancing cap by twisting it back on tightly.

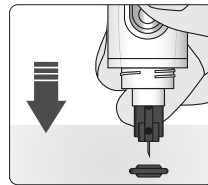

Push the needle into the protective cover.

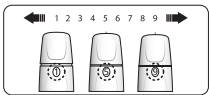

To adjust the depth setting: Use 1-3 for soft skin, 4-6 for average skin, and 7-9 for thick or calloused skin.

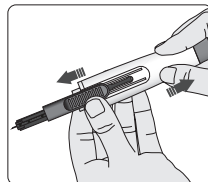

Pull the lancet out. Be sure to contact your Healthcare Provider for instructions on disposing of your lancets.

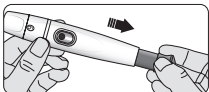

Pull the end of the lancet device back.

Easy•Touch® Lancing Device w/ Ejector

Alternate Site Testing

The clear lancing device cap is used for alternate site testing

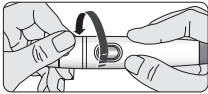

Remove the lancing cap by twisting off.

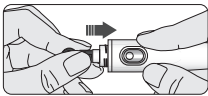

Insert a lancet and replace with the clear cap.



To bring fresh blood to the surface of the test site, rub the test site vigorously for a few seconds until you feel it getting warm. Applying a heating pad may be helpful.

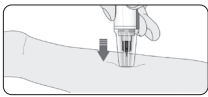

Hold the clear cap down against a fleshy area on the alternate site and press the release button. Do not lift up. Continue to hold the lancing device and gradually increase pressure for several seconds.

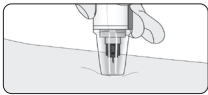

While holding the lancing device on your test site, look through the clear cap until a round drop of blood appears (approximately 0.5ul).

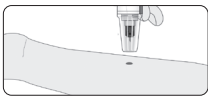

Lift the lancing device straight up; be careful not to smear the blood on your testing site.



Place the edge of the test site to the drop of blood. The blood will be automatically drawn up.

NOTE

The AST (Alternate Site Testing) tip is not included with the EasyTouch® Lancing Device w/ Ejector but can be purchased separately. For purchasing information, please call customer support toll free: 877-358-4342. (Mon-Fri, 9am-5pm, EST)

REMEMBER

- Consult with your Healthcare Professional before using alternate site testing.
- Choose a different puncture site each time you test. Repeated punctures in the same spot may cause soreness and calluses.
- If bruising occurs at an alternative site or you have difficulty getting a sample, consider sampling from a fingertip instead. You may want to review the choice of sites with your Healthcare Professional.
- Do not share your reusable lancing device with anyone including other family members.

CAUTION

Do not test on your upper arm, forearm, dorsal hand, ventral palm, thigh, or calf when:

- You think your blood glucose is rapidly falling. For example within two hours of exercise, rapid-action insulin injection, or an insulin pump bolus.
- Testing with a fingertip sample may identify hypoglycemia or an insulin reaction sooner than testing with a forearm or palm sample.



Questions or Comments?
Call 877.358.4342

MHC Medical Products, LLC

8695 Seward Road, Fairfield, OH 45011
Made in China. Distributed by MHC Medical Products.

EasyTouch® is a trademark of MHC Medical Products, LLC.